



57 Lyle Street Girraween NSW

4  2  3 

Once in a while a home comes to market that takes your breath away and this is one such home!

Situated on the high side of a quiet street, enjoying a northerly aspect this large home offers a spacious versatile floor plan to suit your extended family's needs. It's so easy to convert this home into a 5 or 6 bedroom home and the rooms would be large!!!

Price : \$ 771,000

Land Size : 556 sqm

View : <https://www.elderstoongabbie.com.au/sale/nsw/parramatta/girraween/residential/house/5875299>

GROUND FLOOR

- Large sun drenched lounge and big dining space with polished floor boards.
- Great kitchen with abundant cupboard space.
- Impressive and large sunroom with glassed views to low maintenance paved backyard
- 3 bedrooms, main bathroom, separate toilet



Nick Bardon
02 9896 2333

57 Lyle Street Girraween

ESTABLISHED GARDEN OFFSHOOT

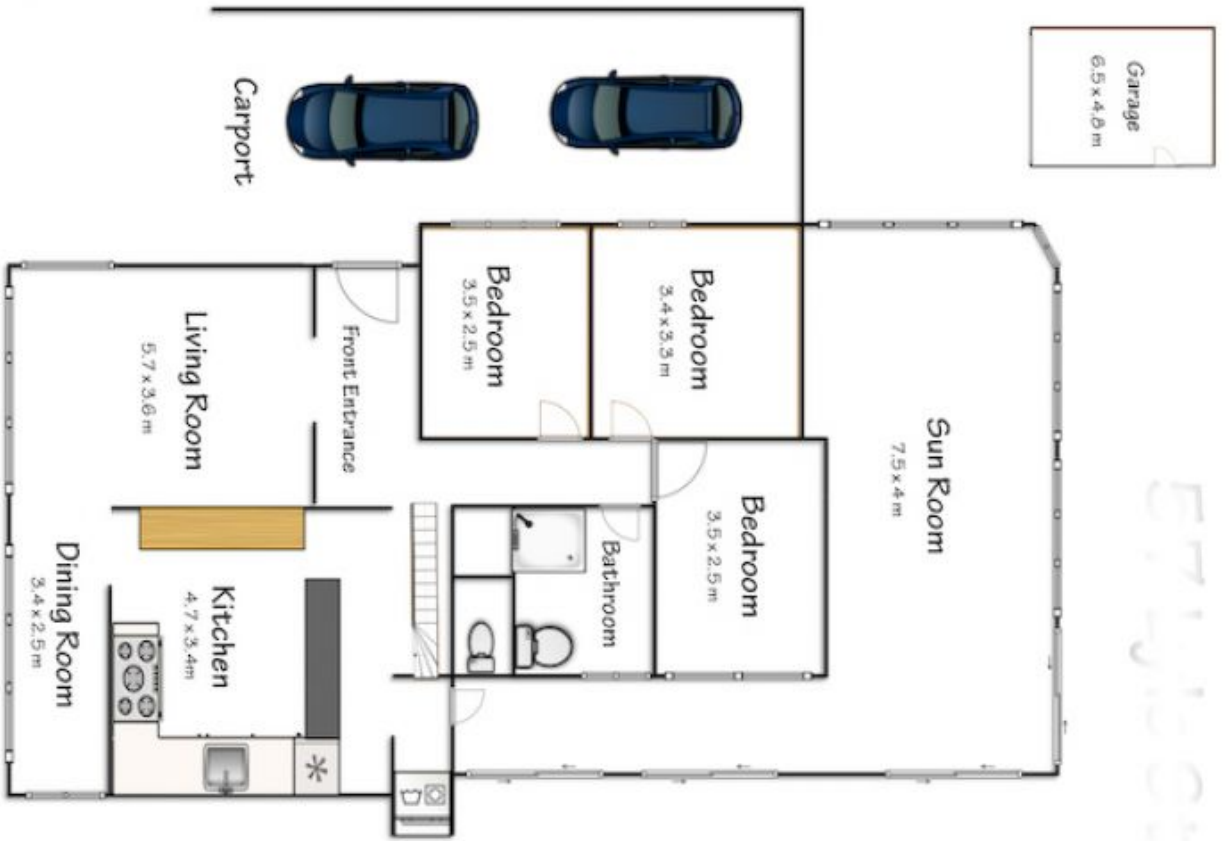

Ground Floor



Top Floor

Measurements are approximate and not to scale.
Illustrative and perceptual purposes only.