

Elders



1/42-44 Gilba Road Girraween NSW

3  1  2 

Affordable first home or astute investment, the choice is yours. Located in a highly convenient position within 10 minutes walking distance to Pendle Hill train station and even closer to Girraween Public and selective High Schools, this modern 3 bedroom townhouse will impress and delight.

Situated within an excellent complex of only 7 properties of which 6 are owner occupied, you will enjoy living here not only for the convenient location but also the friendly neighbourhood.

Modern features include a gas equipped granite topped kitchen, gas hot water, gas heating provision, security alarm, split system air conditioning in the living areas and main bedroom, and a lock up garage with remote control door and drive through access to a second car space in the

Price : \$ 467,500
Land Size : 198 sqm
View : <https://www.elderstoongabbie.com.au/sale/nsw/parramatta/girraween/residential/house/5875320>



Nick Bardon
02 9896 2333

<https://www.elderstoongabbie.com.au>

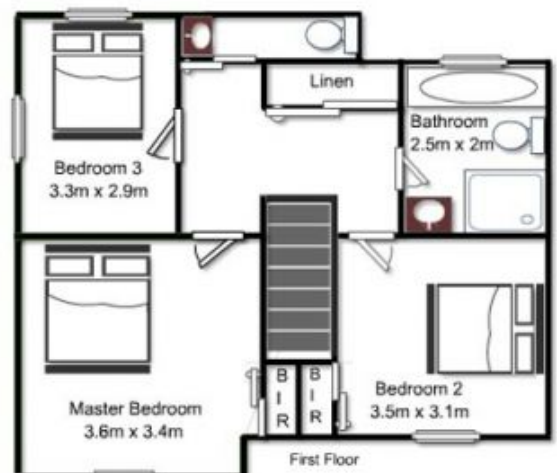

Plans are for presentation purposes only and are not part of any legal document or title. They should not be used as sole reference. Interested parties should make their own enquiries using other sources. Measurements are approximates.