



Elders



13/8-10 Metella Road Toongabbie NSW

3  2  1 

If space, convenience and modern living are your priority then this could be the home for you. Situated within 5 minutes walking distance to the train station, shopping centre and within close walking distance also to excellent public and private schooling options this 3 bedroom townhouse should be added to the top of your inspection list.

You will enjoy all day sunshine throughout the home and main courtyard thanks to the Northerly aspect. The living areas comprise a spacious air conditioned lounge room with glass sliding doors opening out to the courtyard, a separate dining room opening out to an undercover decking, and a gas equipped kitchen. For added convenience downstairs there is a 3rd toilet adjacent to the laundry and a large under stair storage room.

Price : \$ 490,000
Land Size : 251 sqm
View : <https://www.elderstoongabbie.com.au/sale/nsw/western-sydney/toongabbie/residential/townhouse/5875615>



Nick Bardon
02 9896 2333

<https://www.elderstoongabbie.com.au>

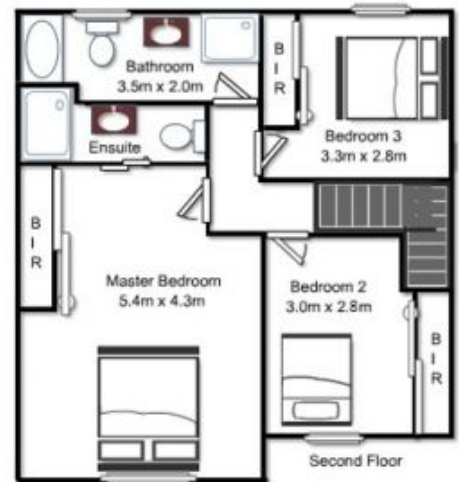

Plans are for presentation purposes only and are not part of any legal document or title. They should not be used as sole reference. Interested parties should make their own enquiries using other sources. Measurements are approximates.